



SIMARINE



Simarine Systems Description with Diagrams

Pico Smart Monitoring System

The PICO system is designed for precise monitoring of batteries, tanks, temperatures and other parameters on the yacht.

It consists of 3.5-inch-high resolution IP67 display unit and corresponding sensor modules.



Simarine App

The integrated WiFi connectivity allows easy configuration process via iOS and Android SIMARINE App.

At the same time the Apps offer users the chance to monitor all data.

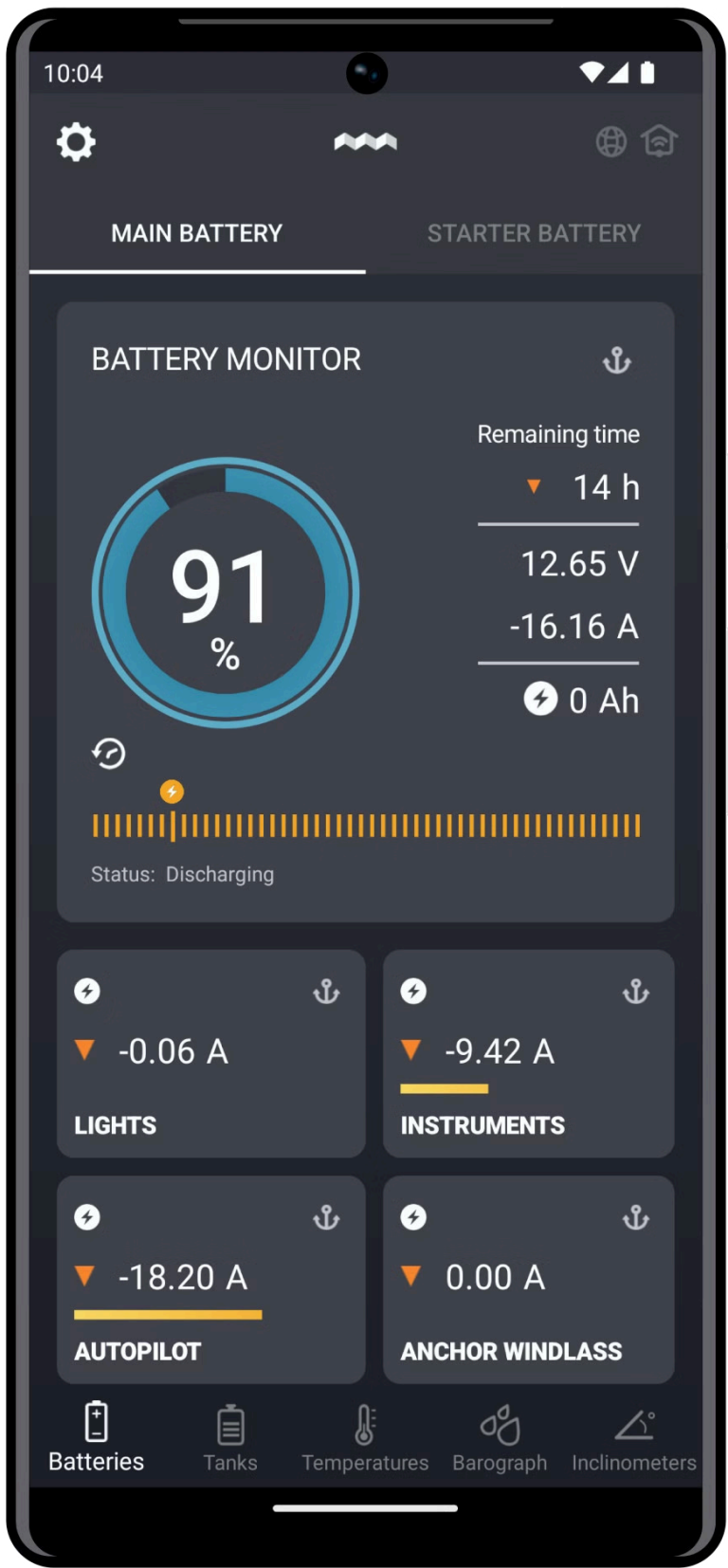

PICO - Basic System

The basic system consists of a PICO display unit, a 300A or 500A shunt (SC303 or SC503)

for the main battery and a tank module (ST107).

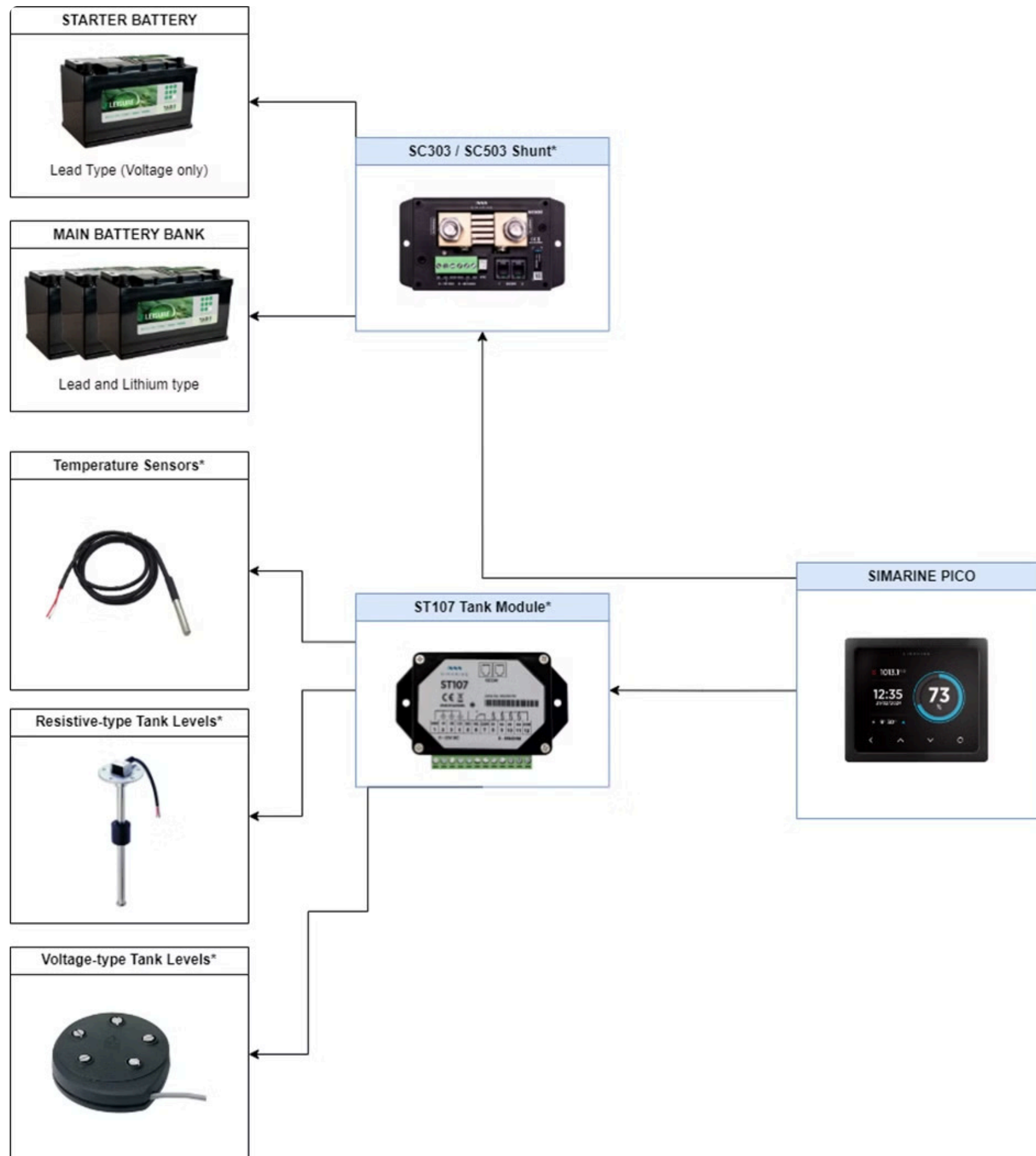

- Multiple units or modules can be added to the system

PICO - Extended System

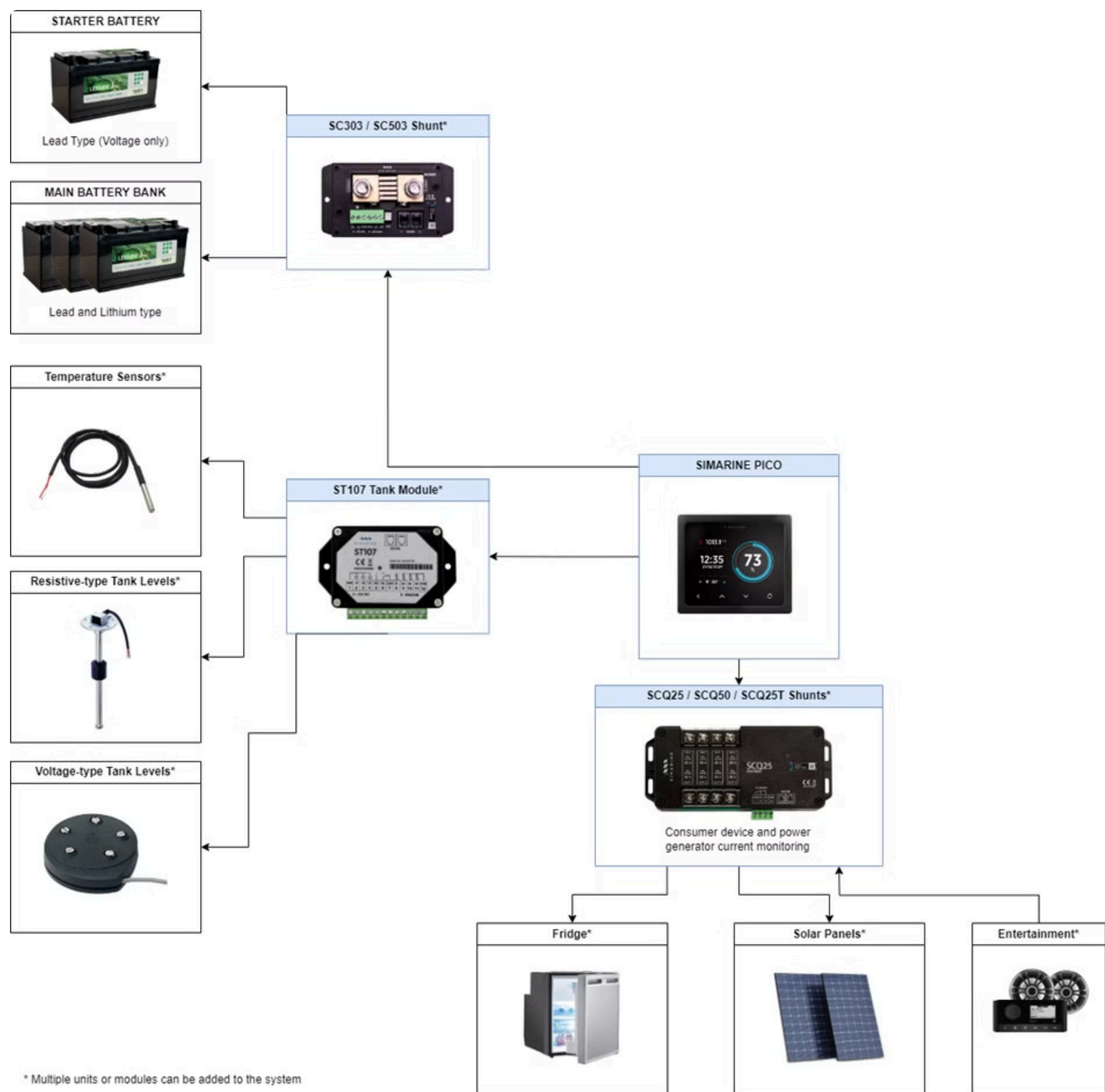

The system can be extended with our unique micro shunts modules (SCQ25, SCQ25T and SCQ50)

to monitor individual DC consumer and power generation devices.

PICO - Full Monitoring System

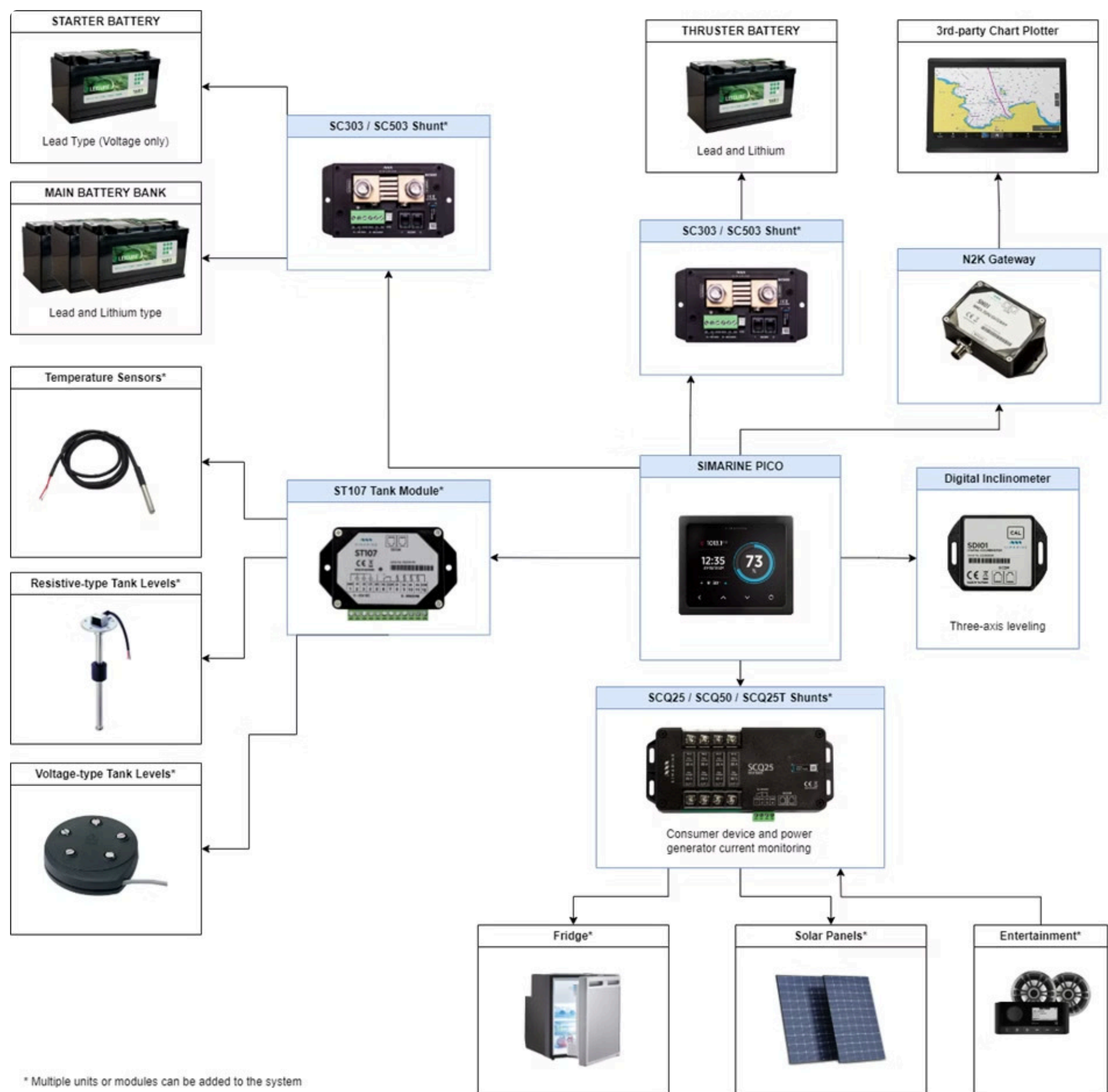

For a full-fledged PICO system, additional shunts (up to 6) can be added for thrusters, winches and starter batteries as well

as a N2K gateway to display PICO data on a third-party plotter as well as inclinometer module for 3-axis leveling.

Pico Smart Monitoring and Switching System

In combination with the VIA SPDU-66 DC distribution unit and VIA Keypad or third-party traditional switches, PICO becomes a versatile and expandable digital switching platform.



PICO - Basic Switching System

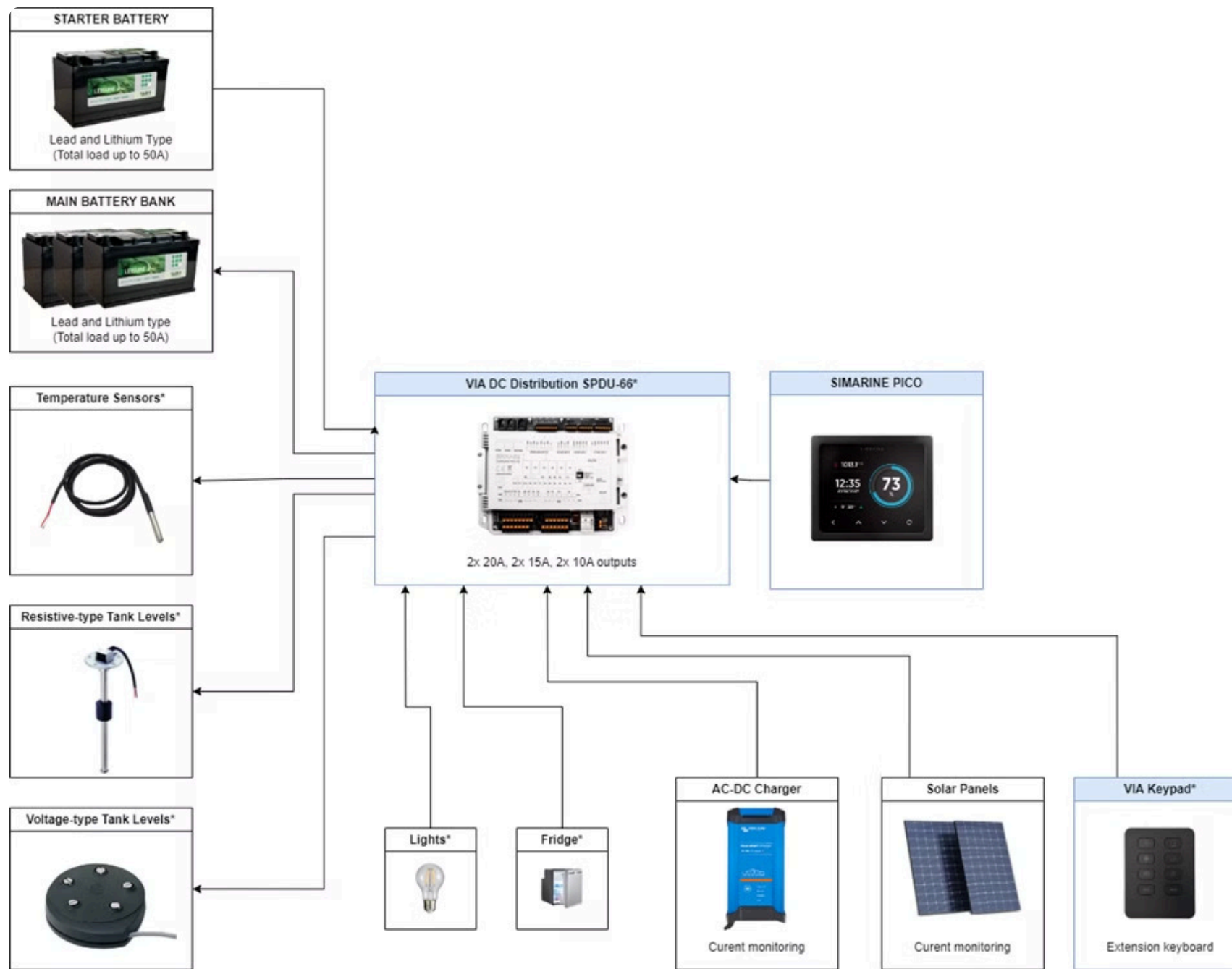

The Basic Switching system consists of a PICO display, SPDU-66 distribution unit and a VIA Keypad.

This provides all the functions required for an entry level system for digital switchable boat.

PICO - Extended Switching System

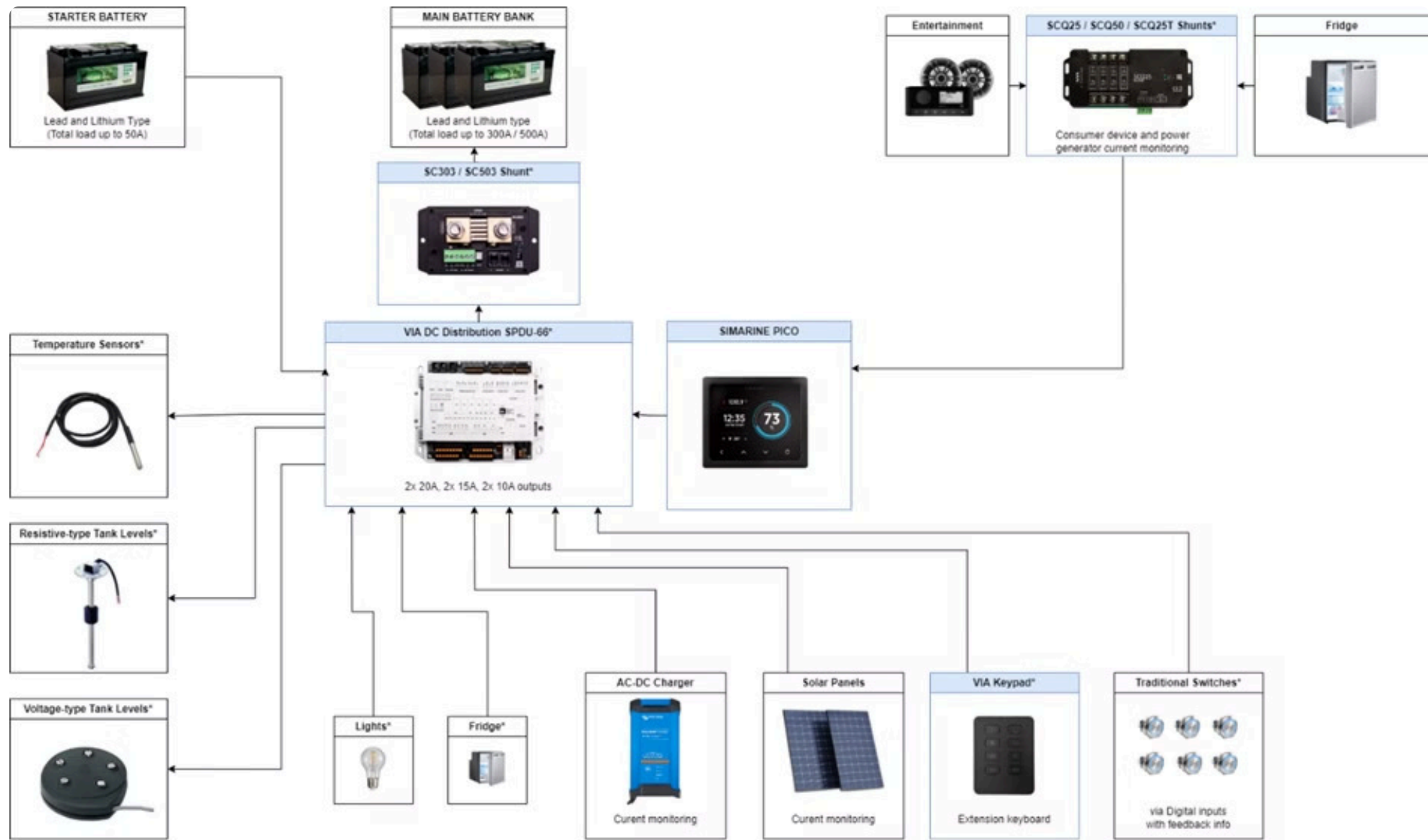

Additionally, the system can be extended with an additional shunt in case higher currents are drawn from the main battery bank, for example, if an inverter is installed.

An SCQ25 or SCQ50 can be added for precise monitoring of consumers. Traditional switches with feedback options can also be added to upgrade the dashboard with digital switching capabilities.

An extra shunt can be added in case higher currents are needed on the main battery bank.

PICO - Full Switching System

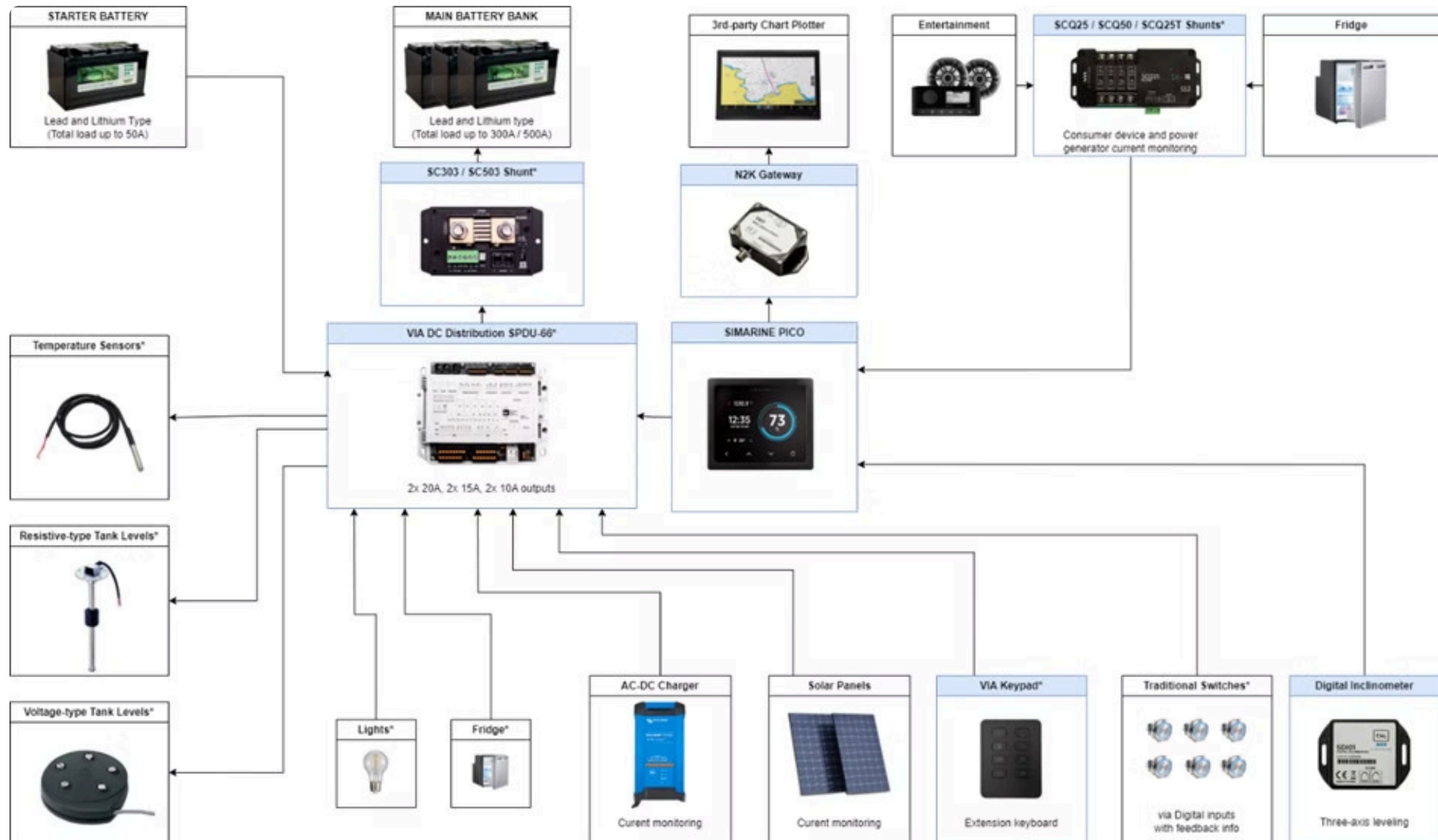

For a full-fledged system, a N2K Gateway can be added to connect a third-party chart plotter

and an inclinometer module for three-axis leveling.

VIA Digital Switching and Monitoring System

VIA Digital Switching system is designed for smaller sized modern boats and sailing boats for customers, who want to use all the benefits of digital switching as well as comprehensive monitoring of batteries, tanks, temperatures and other parameters.

The system offers multiple wiring options and allows multiple switching and distribution units if additional switching capabilities are needed.



Simarine App

The integrated Wi-Fi connectivity allows easy configuration process via iOS and Android SIMARINE App.

At the same time, the Apps offer users the chance to monitor all the data as well as toggle the switches on and off.

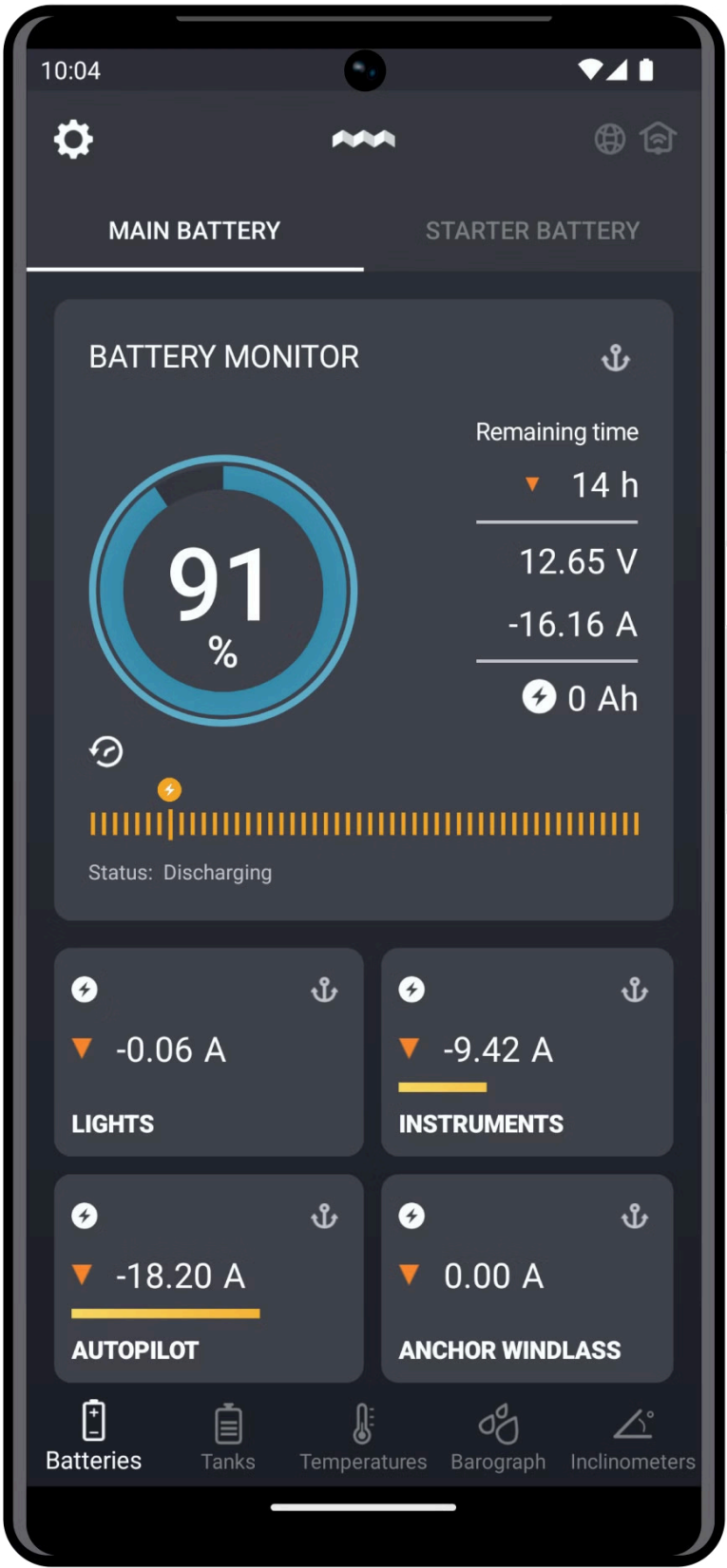

VIA Basic Switching and Monitoring System

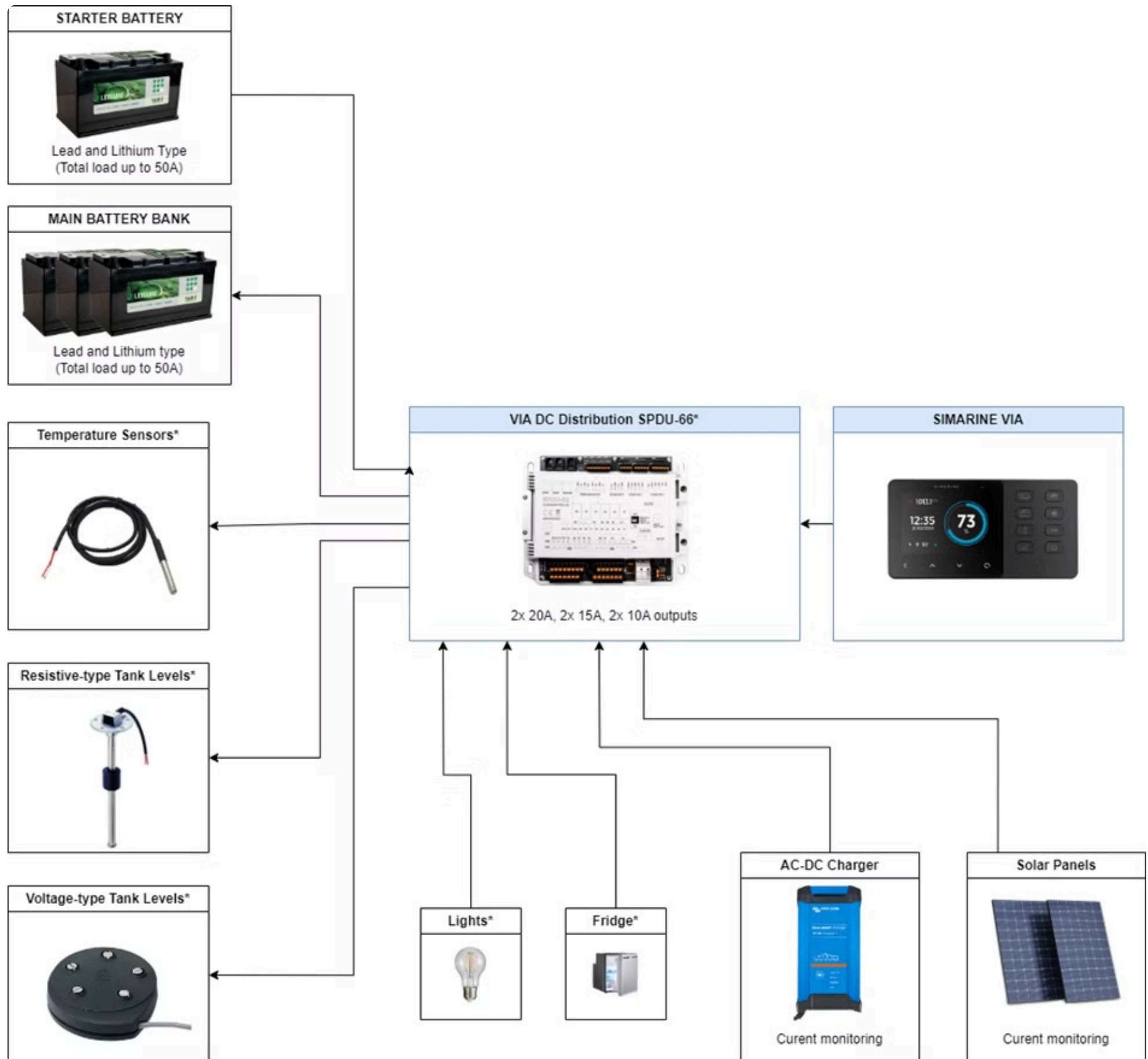

The basic VIA digital switching and Monitoring System consists of a VIA panel and a SPDU-66 DC Distribution Unit,

which allows connection of multiple tank level sensors, temperature sensors, 50A shunt for main battery bank, 50A shunt for starter battery, 50A shunt for AC charger, 50A shunt for solar panels.

VIA Basic Switching + Inverter

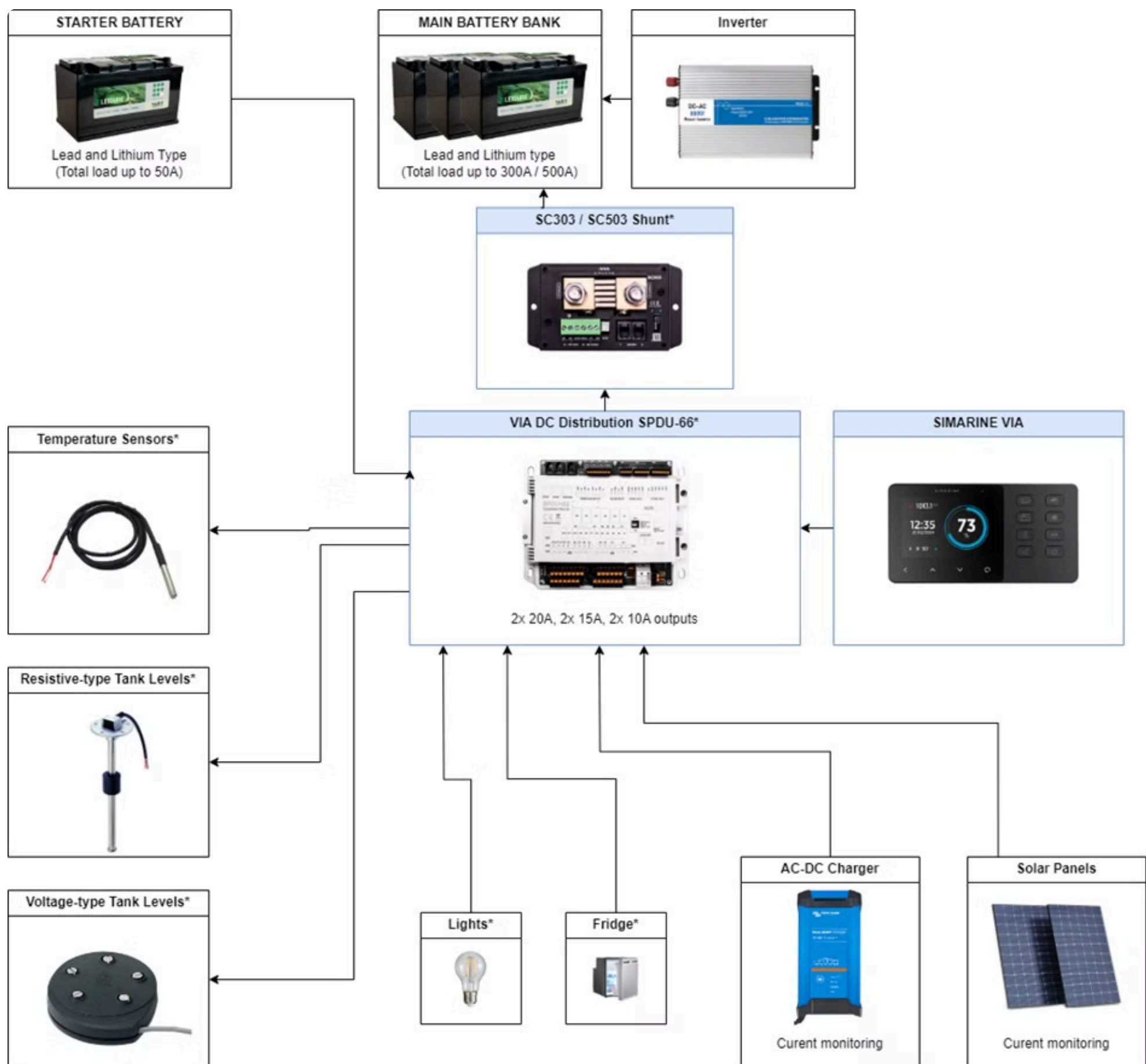

Additionally, an additional shunt can be used in case higher currents are drawn from the main battery bank,

for example if an inverter is installed.

VIA - Extended Switching and Monitoring System

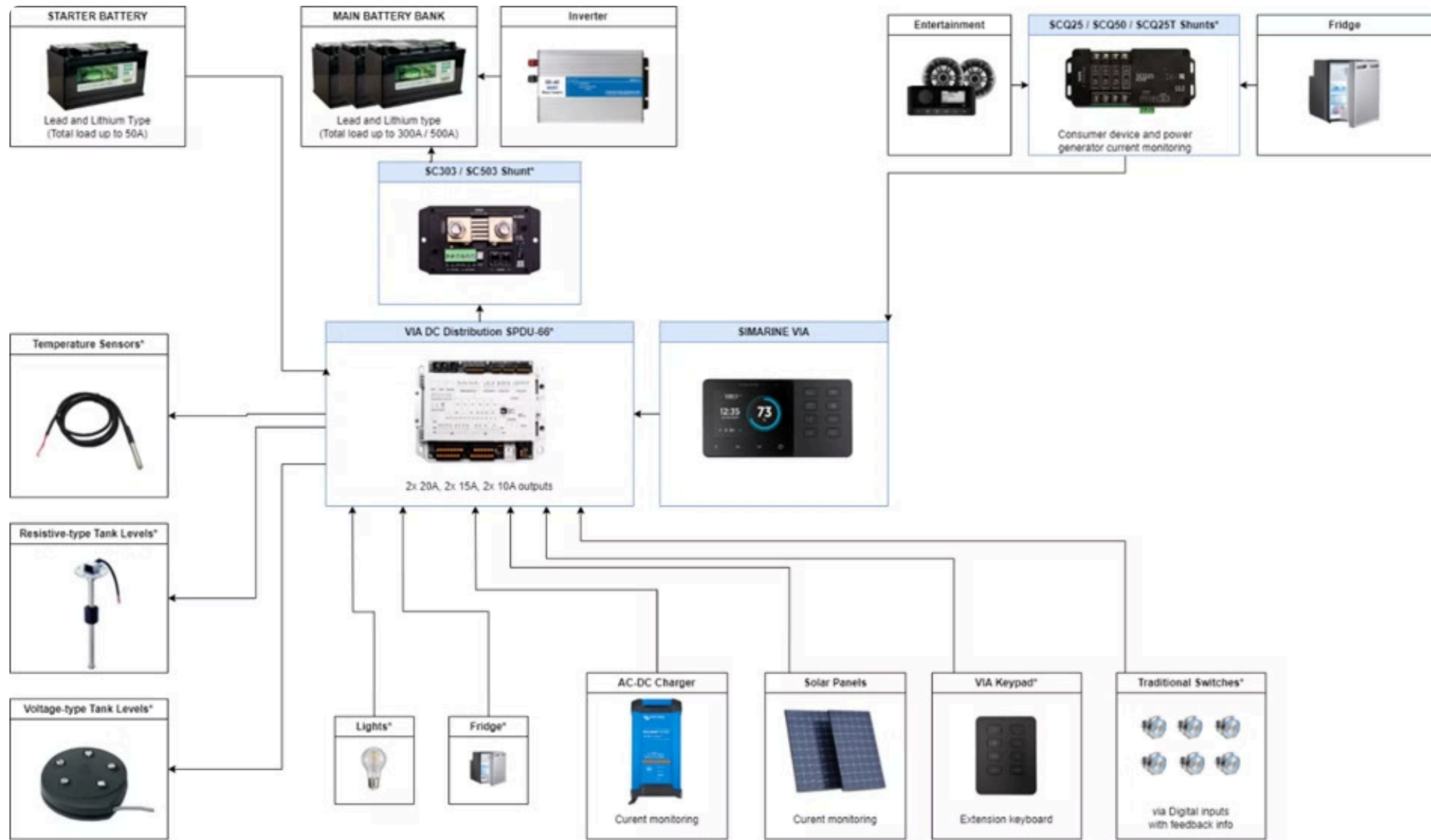

The system can be further extended with the VIA Keypad unit making it possible to control some switching from a different room inside the boat.

Alternatively, third-party traditional switches with feedback function can be used via the integrated 6 digital inputs.

VIA - Full Switching and Monitoring System

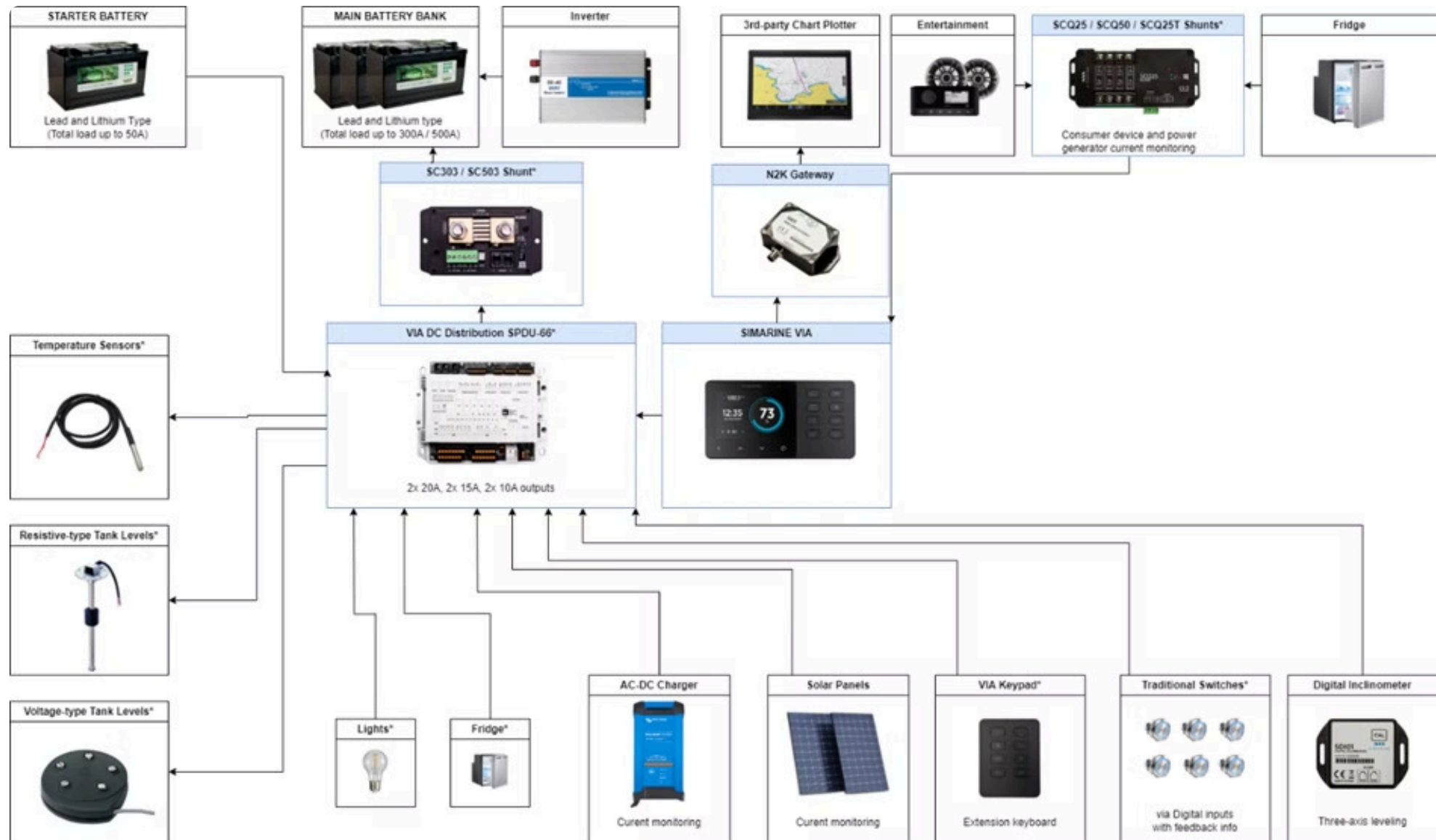

For a full-fledged system, additional SCQ25 or SCQ50 micro shunts can be added to the VIA system, turning it into a complete monitoring and digital switching system, which allows monitoring multiple battery banks and consumer/generator devices.

A N2K Gateway can be added to connect a third-party chart plotter and an inclinometer module for three-axis leveling.

VIA - Victron Integration

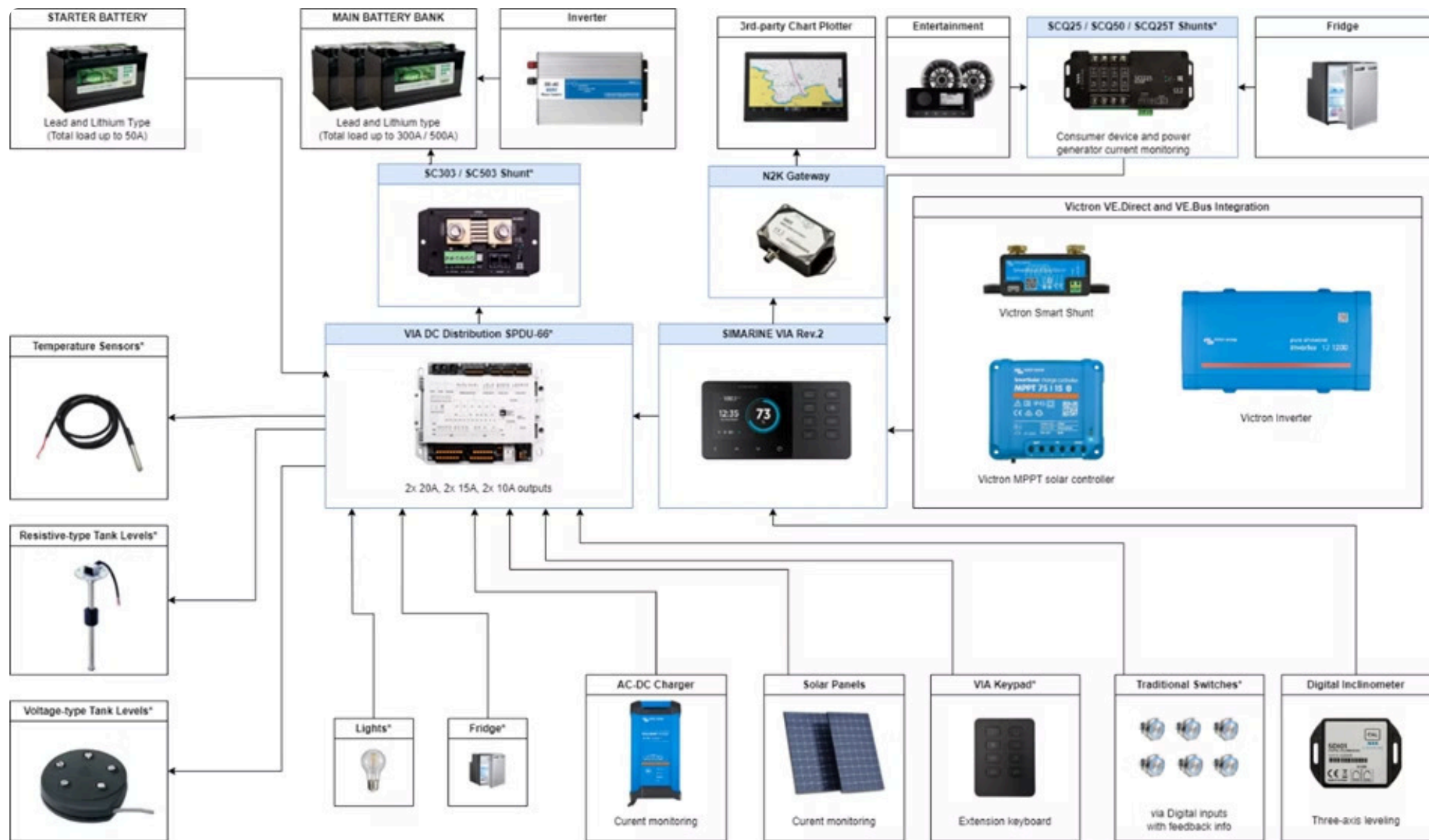

The new Victron integration allows plug-and-play compatibility for a seamless integration with Victron Energy devices such as Inverters, Solar Charge controllers and shunts.

SIMARINE VIA Rev 2.0 allows monitoring as well as controlling a majority of Victron Energy devices over VE. Direct, VE. Bus and VE.CAN protocols.

NEREIDE 2 - Digital Switching and Monitoring System

The Nereide 2 system was designed with larger motor and sailboats in mind and provides a great looking yet simply to operate digital switching panel.

It also includes comprehensive monitoring of batteries, tanks, temperatures and other parameters.

It offers significantly higher number of switches comparing to VIA, on board N2K integrations, higher currents on the DC distribution units

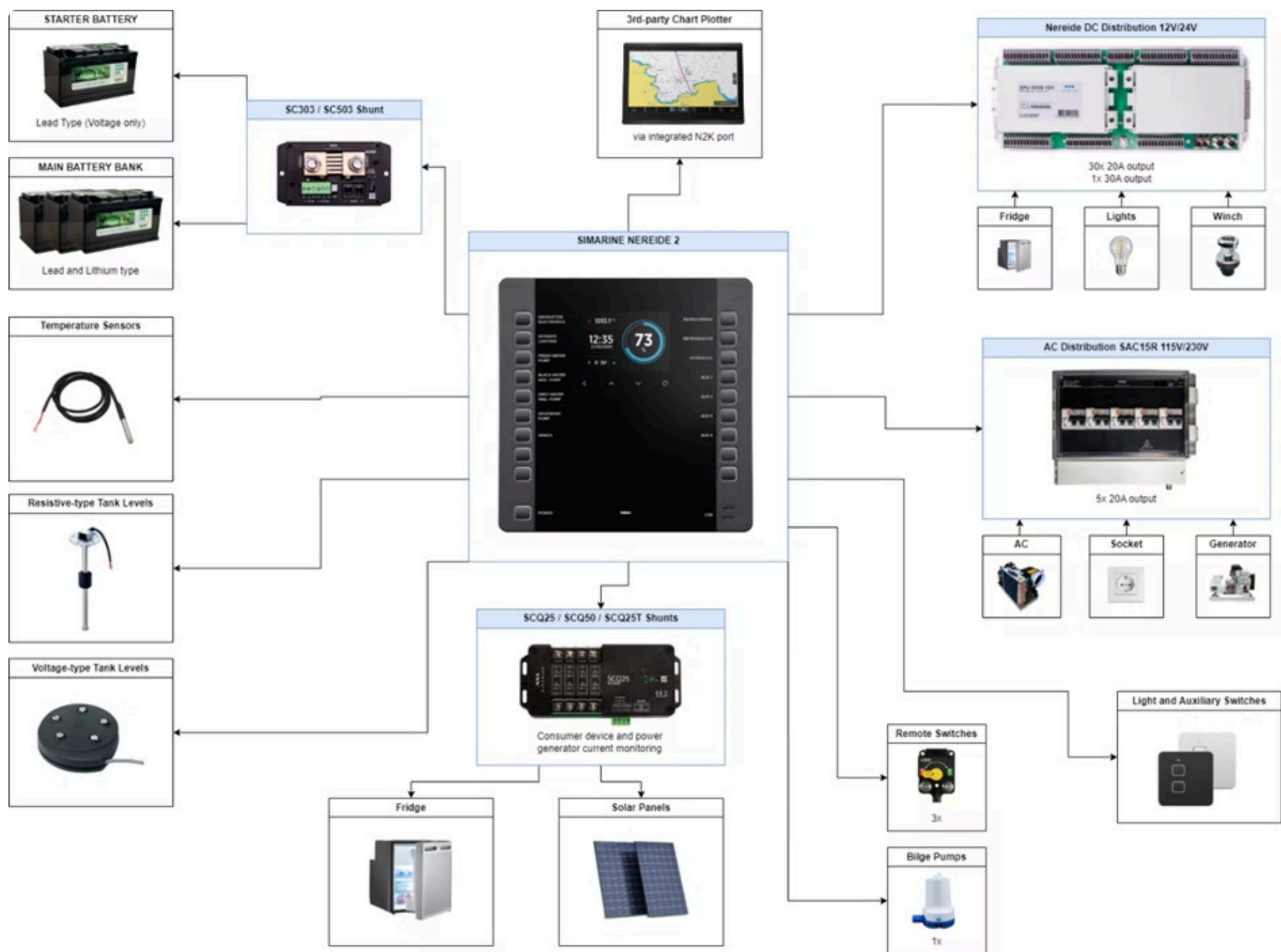

- A dedicated AC distribution unit for controlling the 230V and 115V AC devices is available with standard (SAC15) or fully motorized (SAC15R) reclosers for safe and seamless installation and operation.
- One bilge pump control input with independent power source is available on the back side of the panel as well.
- Remote battery switches with feedback function from third-party providers can be integrated directly on the back side of the panel.
- The system can be extended with Simarine Light or Auxiliary switches or with a digital input unit to accommodate traditional switches with feedback information.

NEREIDE Pro - Digital Switching and Monitoring System

The Nereide Pro system is our flagship digital switching panel, offering unprecedented flexibility while maintaining the simplicity of installation as well as operation.

A single button can combine multiple functions at once. Multiple DC and AC distribution can be used to accommodate a staggering 200 switches. It also includes comprehensive monitoring of batteries, tanks, temperatures and other parameters.

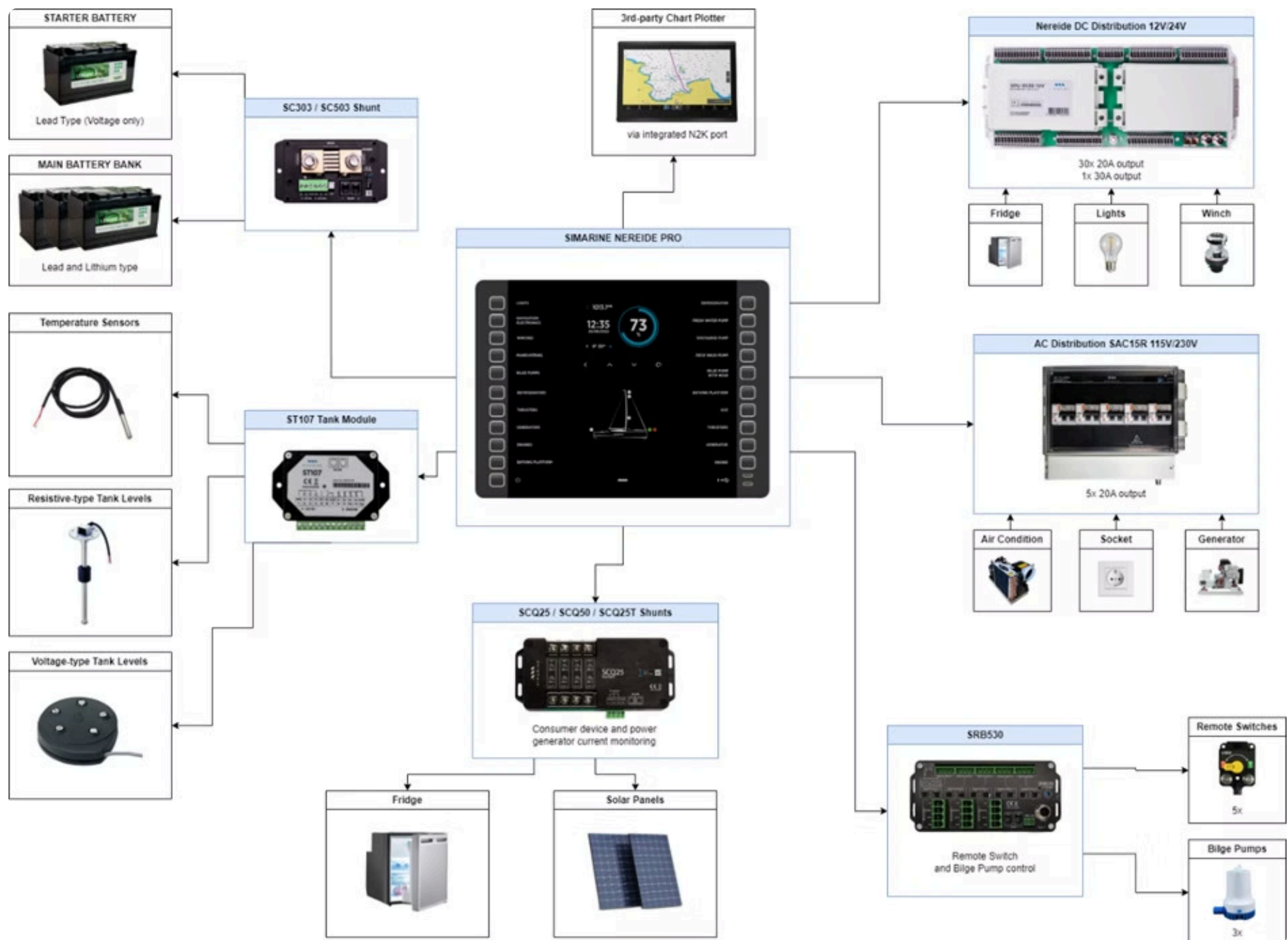

- A dedicated AC distribution unit for controlling the 230V and 115V AC devices is available with standard (SAC15) or fully motorized (SAC15R) reclosers for safe and seamless installation and operation.
- The free of charge Desktop Configuration Utility allows easy configuration and versatility.
- The SRB530 unit allows the control of 5x Remote battery switches with feedback function from third-party providers and 3x Bilge pumps.
- The system can be extended with Simarine Light or Auxiliary switches or with a digital input unit to accommodate traditional switches with feedback information.